

ABBEY

Abbey Fresno ABS 19.5X120R



PRICE / M2 (VAT INCLUDED)

CHARACTERISTICS

Finish: Natural

Utilization groups: 4 - For high traffic

Boxes / Pallet: 45

Rectified sides

Kg / Box: 31.43

Kg / Pallet: 1414.44

Degree of detonation: V3 (Medium)

Material: Full body porcelain tiles

Pieces / Box: 8

M2 / Box: 1.87

M2 / Pallet: 84.15



Installation

Installation: Pavement



Critical angle of slip in wet areas when walking barefoot (DIN 51097 - Ramp)

Critical angle of slip in wet areas when walking barefoot (DIN 51097 - Ramp):

White Body



mm

Colored Porcelain

Highly resistant tiles for all types of floor and wall applications, interior, exterior, facades as well as bathrooms and kitchens.



Critical angle of slip (DIN 51130 - Ramp)

Critical sliding angle (DIN 51130 - Ramp): R-11



Slip resistance (CTE ENV 12633 - Pendulum)

Slip resistance (CTE ENV 12633 - Pendulum): Clase 1



Recycling

Recycled:

Abbey

Simple elegance With Abbey any interior will give in to the warm charm of untreated wood. A simple, unadorned floor tile that expresses its naturalness in long planks that pay tribute to rustic floorings. Far from tricks and fanfare, this tuttomassa floor tile unfolds in traditional colors and shades: Fresno, Roble, Visón and Gris. A high-quality porcelain proposal available in two different lengths with a natural or antislip finish for outdoor or water areas. Range available in 19.5x120 R cm

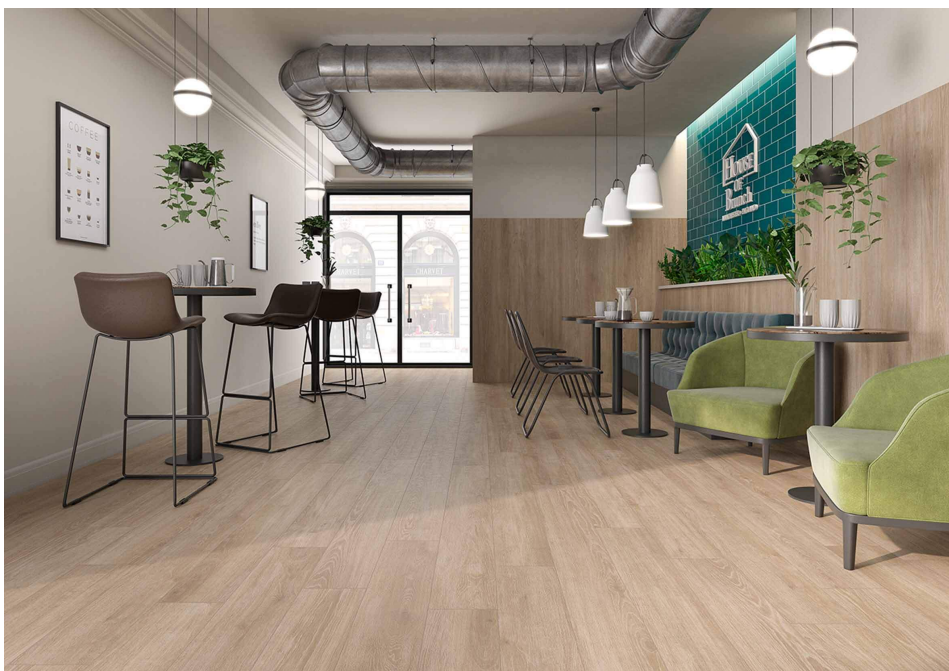

MANUALS AND RESOURCES



Product technical certificate

#technology_text

White Body

Colored Porcelain

Highly resistant tiles for all types of floor and wall applications, interior, exterior, facades as well as bathrooms and kitchens.